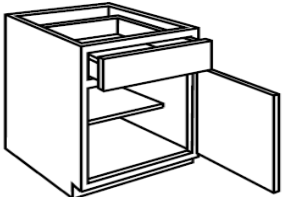

DL CABINETS-SPECIFICATION BOOK

BASE CABINET

BASE CABINET-1 DRAWER, 1 DOOR, 1 ADJUSTABLE SHELF

		ITEM CODE	WIDTH	HEIGHT	DEPTH
		B09	9"	34½"	24"
		B12	12"	34½"	24"
		B15	15"	34½"	24"
		B18	18"	34½"	24"
		B21	21"	34½"	24"

BASE CABINET-1 DRAWER, 2 DOOR, 1 ADJUSTABLE SHELF

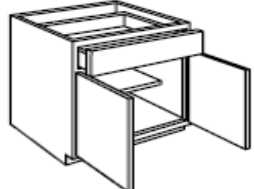
		ITEM CODE	WIDTH	HEIGHT	DEPTH
		B24	24"	34½"	24"
		B27	27"	34½"	24"
		B30	30"	34½"	24"

BASE CABINET- 2 DRAWER, 2 DOOR, 1 ADJUSTABLE SHELF

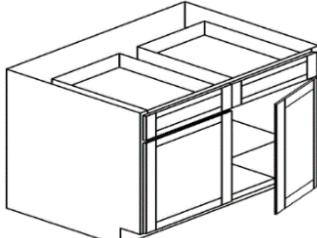
		ITEM CODE	WIDTH	HEIGHT	DEPTH
		B33	33"	34½"	24"
		B36	36"	34½"	24"
		B39	39"	34½"	24"
		B42	42"	34½"	24"

BASE DRAWER CABINET-3 DRAWERS

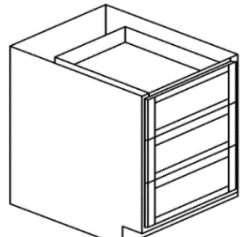
		ITEM CODE	WIDTH	HEIGHT	DEPTH
		DB12	12"	34½"	24"
		DB15	15"	34½"	24"
		DB18	18"	34½"	24"
		DB24	24"	34½"	24"
		DB30	30"	34½"	24"

SINK BASE CABINET-2 DUMMY DRAWERS, 2 DOORS

		ITEM CODE	WIDTH	HEIGHT	DEPTH
		SB36	36"	34½"	24"
		SB42	42"	34½"	24"

WASTE BASKET CABINET-1 DRAWER, 1 PULL-OUT DOOR

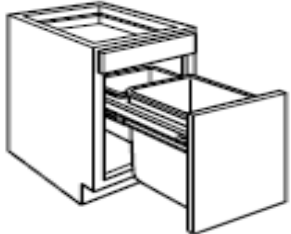
		ITEM CODE	WIDTH	HEIGHT	DEPTH
		BWBKT18	18"	34½"	24"

LAZY SUSAN-2 FULL HEIGHT FOLDING DOORS

		ITEM CODE	WIDTH	HEIGHT	DEPTH
		LZS3312	33"	34½"	24"
		LZS3612	36"	34½"	24"

BASE BLIND CORNER CABINET

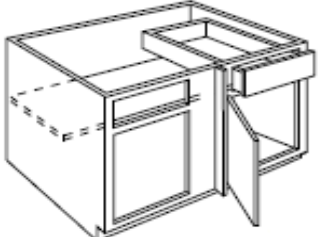
		ITEM CODE	WIDTH	HEIGHT	DEPTH
		BBC36	36"	34½"	24"
		BBC42	42"	34½"	24"

PLEASE NOTE: 3" PULL FROM WALL REQUIRED

BASE SPICE RACK CABINET-1 FULL HEIGHT DOOR(PULL-OUT), 3 FIXED SHELF

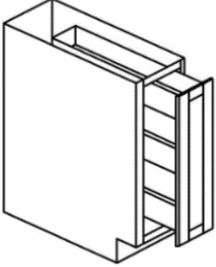
		ITEM CODE	WIDTH	HEIGHT	DEPTH
		SP09	9"	34 1/2 "	24"

BASE END OPEN SHELF-3 FIXED SHELF

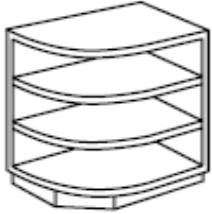
		ITEM CODE	WIDTH	HEIGHT	DEPTH
		BES09	9"	34 1/2 "	24"

BASE END CORNER

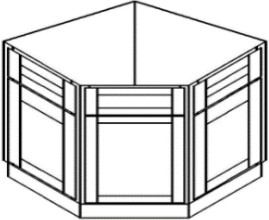
		ITEM CODE	WIDTH	HEIGHT	DEPTH
		BEC	24"	34 1/2 "	24"

WALL CABINET

WALL CABINET-1 DOOR, 2 ADJUSTABLE SHELVES

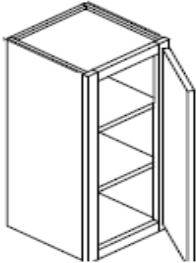
		ITEM CODE	WIDTH	HEIGHT	DEPTH
		W0930	9"	30"	12"
		W1230	12"	30"	12"
		W1530	15"	30"	12"
		W1830	18"	30"	12"
		W2130	21"	30"	12"

WALL CABINET- 2 DOORS, 2 ADJUSTABLE SHELVES

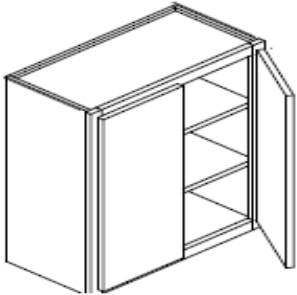
		ITEM CODE	WIDTH	HEIGHT	DEPTH
		W2430	24"	30"	12"
		W2730	27"	30"	12"
		W3030	30"	30"	12"
		W3330	33"	30"	12"
		W3630	36"	30"	12"
		W3930	39"	30"	12"
		W4230	42"	30"	12"

WALL CABINET - 1 DOOR, 3 ADJUSTABLE SHELVES

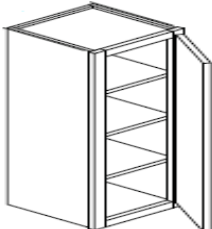
		ITEM CODE	WIDTH	HEIGHT	DEPTH
		W0936	9"	36"	12"
		W1236	12"	36"	12"
		W1536	15"	36"	12"
		W1836	18"	36"	12"
		W2136	21"	36"	12"

WALL CABINET- 2 DOORS, 3 ADJUSTABLE SHELVES

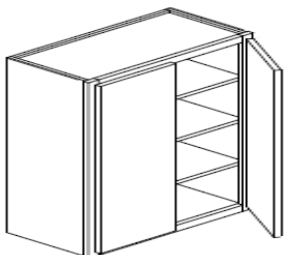
		ITEM CODE	WIDTH	HEIGHT	DEPTH
		W2442	24"	42"	12"
		W2742	27"	42"	12"
		W3042	30"	42"	12"
		W3342	33"	42"	12"
		W3642	36"	42"	12"
		W3942	39"	42"	12"
		W4242	42"	42"	12"

WALL CABINET - 2 DOORS, NO SHELF

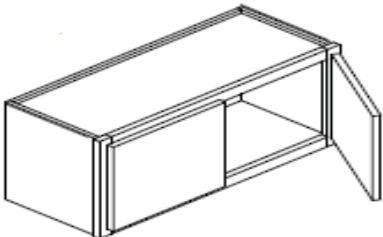
		ITEM CODE	WIDTH	HEIGHT	DEPTH
		W3012	30"	12"	12"
		W3015	30"	15"	12"
		W3018	30"	18"	12"
		W3612 27	36"	12"	27"
		W3615 27	36"	15"	27"
		W3618 27	36"	18"	27"

WALL CABINET - 2 DOORS, 1 ADJUSTABLE SHELF

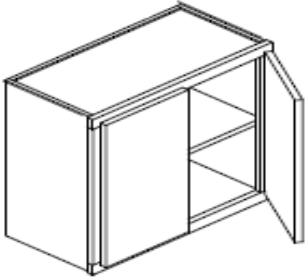
				
	ITEM CODE	WIDTH	HEIGHT	DEPTH
	W3024	30"	24"	12"
	W3624 27	36"	24"	27"

WALL DIAGONAL CORNER - 1 DOOR, 2 ADJUSTABLE SHELVES

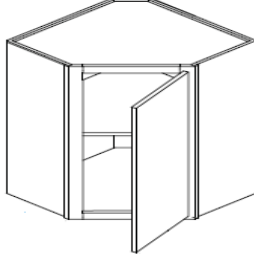
				
	ITEM CODE	WIDTH	HEIGHT	DEPTH
	WDC243012	24"	30"	12"
	WDC243615	24"	36"	12"

WALL DIAGONAL CORNER - 1 DOOR, 3 ADJUSTABLE SHELVES

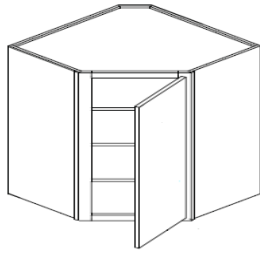
				
	ITEM CODE	WIDTH	HEIGHT	DEPTH
	WDC244215	24"	42"	15"

STEM GLASS HOLDER

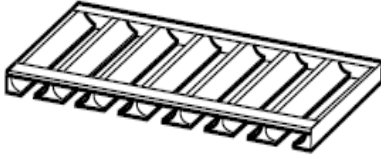
	ITEM CODE	WIDTH	DEPTH	
	GH30	30"	12"	
	GH36	36"	12"	

WALL WINE RACK

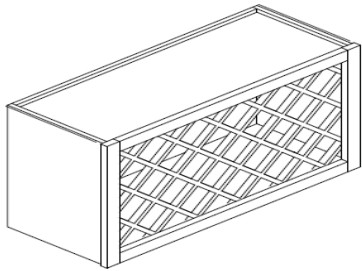

ITEM CODE	WIDTH	HEIGHT	DEPTH
WRC3018	30"	18"	12"
WRC3618	36"	18"	12"

WALL OPEN END SHELF - NO DOOR, 2 FIXED SHELVES

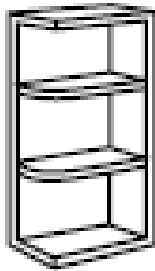

ITEM CODE	WIDTH	HEIGHT	DEPTH
WEOS930	9"	30"	12"
WEOS936	9"	36"	12"

WALL OPEN END SHELF - NO DOOR, 3 FIXED SHELVES

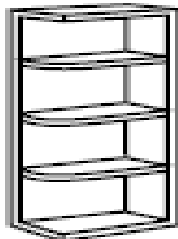

ITEM CODE	WIDTH	HEIGHT	DEPTH
WOES942	9"	42"	12"

WALL END CORNER- 2 DOORS, 2 SHELVES

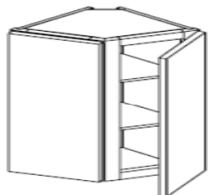

ITEM CODE	WIDTH	HEIGHT	DEPTH
WEC1230	12"	30"	12"
WEC1236	12"	36"	12"

WALL END CORNER- 2 DOORS, 3 SHELVES

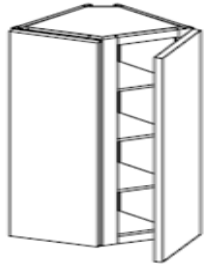

ITEM CODE	WIDTH	HEIGHT	DEPTH
WEC1242	12"	42"	12"

WALL MICROWAVE CABINET

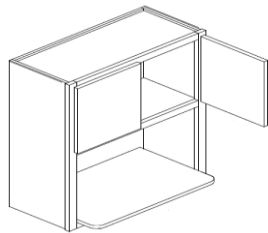

OPENING IS 24" x
15.5"

ITEM CODE	WIDTH	HEIGHT	DEPTH
WMC2730	27"	30"	12"
WMC2736	27"	36"	12"
WMC2742	27"	42"	12"

Bottom shelf depth is 18 1/4"

GLASS DOOR WITH MULLIONS

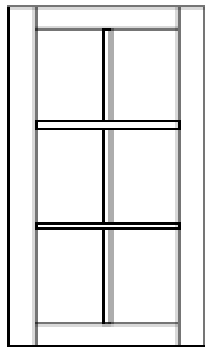

ITEM CODE	WIDTH	HEIGHT	THICKNESS
WG1230	12"	30"	3/4 "
WG1530	15"	30"	3/4 "
WG1830	18"	30"	3/4 "
WG1236	12"	36"	3/4 "
WG1536	15"	36"	3/4 "
WG1836	18"	36"	3/4 "
WG1242	12"	42"	3/4 "
WG1542	15"	42"	3/4 "
WG1842	18"	42"	3/4 "
WDCG243012*	15"	30	3/4 "
WDCG243615	12 3/4"	36	3/4 "
WDCG244215	12 3/4"	42	3/4 "

TALL CABINETS

TALL PANTRY, 1 UPPER DOOR AND 1 LOWER DOOR

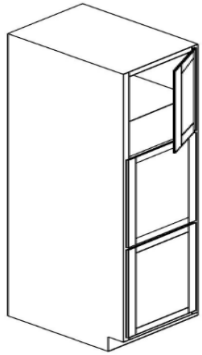

ITEM CODE	WIDTH	HEIGHT	DEPTH
WP1884	18"	84"	27"
WP1890	18"	90"	27"
WP1896	18"	96"	27"

TALL PANTRY - 2 UPPER DOORS AND 2 LOWER DOORS

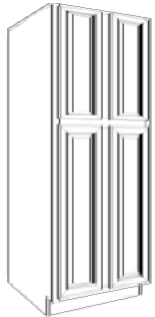

ITEM CODE	WIDTH	HEIGHT	DEPTH
WP2484	24"	84"	27"
WP2490	24"	90"	27"
WP2496	24"	96"	27"

DOUBLE OVEN CABINET - 2 UPPER DOORS AND 1 LOWER DRAWER

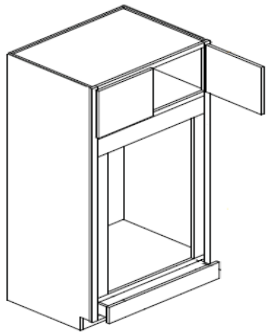

ITEM CODE	WIDTH	HEIGHT	DEPTH
OVD308427	30"	84"	27"
OVD309027	30"	90"	27"
OVD309627	30"	96"	27"
OVD338427	33"	84"	27"
OVD339027	33"	90"	27"
OVD339627	33"	96"	27"

VANITY CABINETS

VANITY DRAWER BASE CABINET - 3 DRAWERS

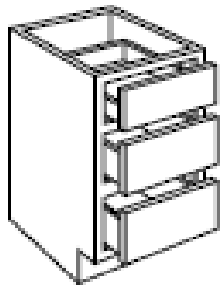

ITEM CODE	WIDTH	HEIGHT	DEPTH
VDB12	12"	34 1/2 "	21"
VDB15	15"	34 1/2 "	21"
VDB18	18"	34 1/2 "	21"

VANITY SINK BASE CABINET - 1 DUMMY DRAWER, 2 DOORS

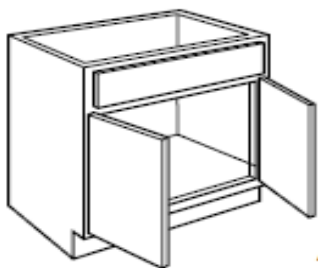

ITEM CODE	WIDTH	HEIGHT	DEPTH
VAN24	24"	34 1/2 "	21"
VAN30	30"	34 1/2 "	21"

VANITY SINK BASE CABINET - 1 DUMMY DRAWER, 2 DRAWERS, 1 DOOR

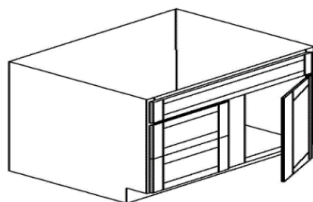

DRAWERS ON THE LEFT, DOORS ON THE RIGHT

ITEM CODE	WIDTH	HEIGHT	DEPTH
VAN30DL	30"	34 1/2 "	21"

VANITY SINK BASE CABINET - 1 DUMMY DRAWER, 2 DRAWERS, 1 DOOR

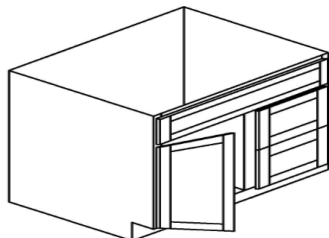

DRAWERS ON THE RIGHT, DOORS ON THE LEFT

ITEM CODE	WIDTH	HEIGHT	DEPTH
VAN30DR	30"	34 1/2 "	21"

VANITY SINK BASE CABINET - 2 DUMMY DRAWER, 2 DRAWERS, 1 DOOR

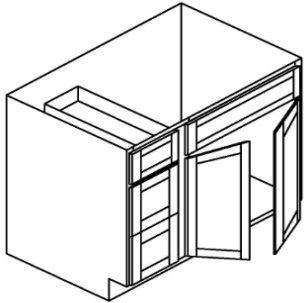
	DRAWERS ON THE LEFT, DOORS ON THE RIGHT	ITEM CODE	WIDTH	HEIGHT	DEPTH
		VAN36DL	36"	34 1/2 "	21"

VANITY SINK BASE CABINET - 2 DUMMY DRAWER, 2 DRAWERS, 1 DOOR

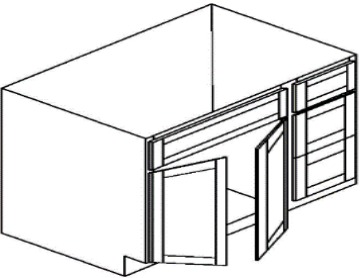
	DRAWERS ON THE RIGHT, DOORS ON THE LEFT	ITEM CODE	WIDTH	HEIGHT	DEPTH
		VAN36DR	36"	34 1/2 "	21"

VANITY SINK BASE CABINET - 6 DRAWERS, 2 DOORS, 1 DUMMY DRAWER

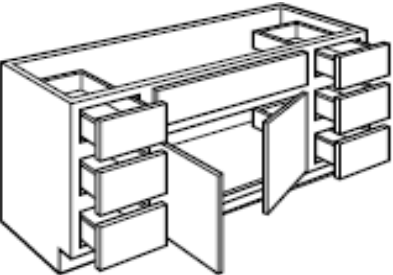
	FOR SINGLE SINK	ITEM CODE	WIDTH	HEIGHT	DEPTH
		VAN48D-6	48"	34 1/2 "	21"
		VAN60D-6	60"	34 1/2 "	21"

VANITY SINK BASE CABINET - 3 DRAWERS, 4 DOORS

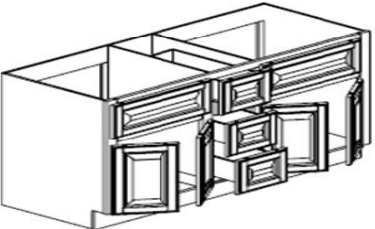
	FOR DOUBLE SINKS	ITEM CODE	WIDTH"	HEIGHT"	DEPTH"
		VAN60DD-3	60"	34 1/2 "	21"
		VAN72DD-3	72"	34 1/2 "	21"

Product Guide-Accessory

WALL DECORATIVE DOOR

			WIDTH	HEIGHT	THICKNESS
		WDD30	11"	29 1/4"	3/4"
		WDD36	11"	35 1/4"	3/4"
		WDD42	11"	41 1/4"	3/4"

BASE DECORATIVE DOOR

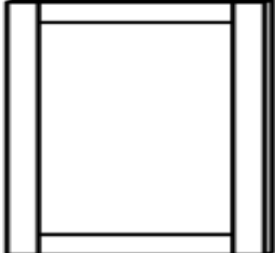
			WIDTH	HEIGHT	THICKNESS
		BDD24	23"	29 1/4"	3/4"

WALL FILLER

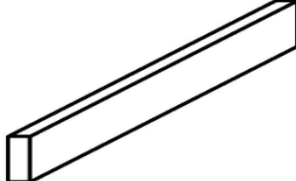
			WIDTH	HEIGHT	THICKNESS
		WF3 30	3"	30"	3/4"
		WF3 36	3"	36"	3/4"
		WF3 42	3"	42"	3/4"
		FILLER 3*96	3"	96"	3/4"
		FILLER 6*96	6"	96"	3/4"

FLUTED FILLER

			WIDTH	HEIGHT	THICKNESS
		FFWF3 96	3"	96"	3/4"

BASE FILLER

	FILLER INCLUDES 4" TOE KICK		WIDTH	HEIGHT	THICKNESS
		BF3	3"	34½"	¾"
		BF6	6"	34½"	¾"

DISHWASHER PANEL

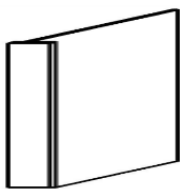
	FRONT FILLER: 3"x34.5" x ¾"		WIDTH	HEIGHT	DEPTH
		DWP3	3"	34½"	24"

REFRIGERATOR PANEL,

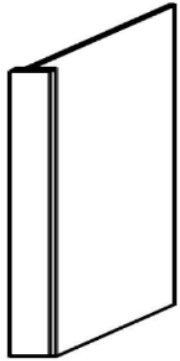
	FRONT FILLER: 3" x¾" x96"		DEPTH	HEIGHT	THICKNESS
		RRP24	24"	96	½"
		RRP27	27"	96	½"

ROYAL CROWN MOLDING

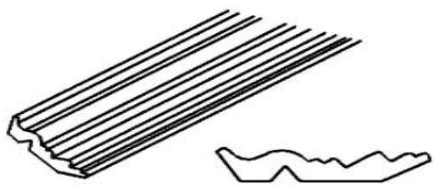
		WIDTH	LENGTH	
	CCM8	4.5"	96"	
	ACM8	2.5"	96"	

BASEMOLDING

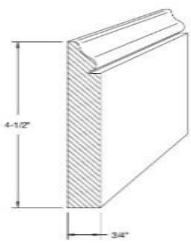
				
		WIDTH	THICKNESS	LENGTH
	BASE MOLDING	4.5"	3/4"	96"

OUTSIDE CORNER MOLDING

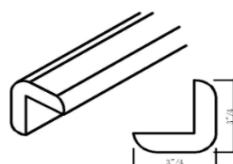
				
		WIDTH	HEIGHT	LENGTH
	ANGLE MOLDING	3/4"	3/4"	96"

INSIDE CORNER MOLDING

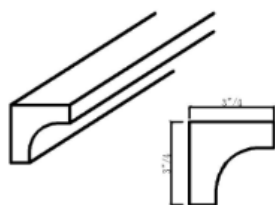
				
	INSIDE CORNER MOLDING	WIDTH	HEIGHT	LENGTH
		3/4"	3/4"	96"

SHOEMOLDING

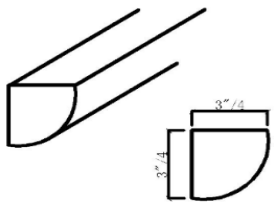
				
		WIDTH	HEIGHT	LENGTH
	SHOEMOLDING	3/4"	3/4"	96"

SCRIBEMOLDING

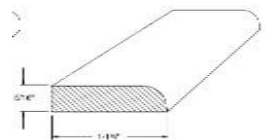
				
		WIDTH	LENGTH	THICKNESS
	SCRIBEMOLDING	3/4"	96"	1/4"

LIGHT RAIL MOLDING

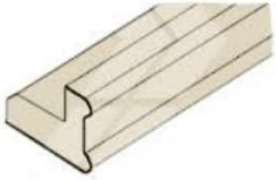
					
			WIDTH	LENGTH	DEPTH
		TLR8	1 3/8"	96"	2"

DECORATIVE FILLER

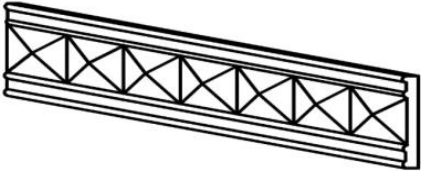
					
			WIDTH	LENGTH	THICKNESS
		LMD	4"	96"	7/8"

DECORATIVE FILLER

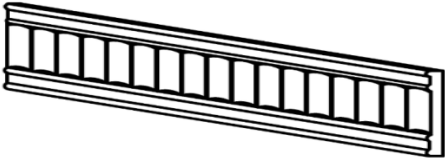



					
			WIDTH	LENGTH	THICKNESS
		LMW	4"	96"	7/8"

VALANCE

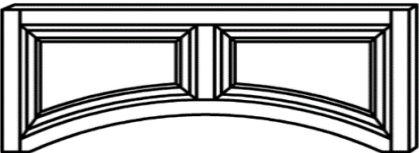
 <p style="text-align: center;">Roman Arch</p>	<p>NOTE: NARROWEST PART IS 3.5", WIDEST IS 6"</p>		WIDTH	HEIGHT	THICKNESS
		VAL36	36"	6"	3/4"
		VAL42	42"	6"	3/4"
		VAL48	48"	6"	3/4"

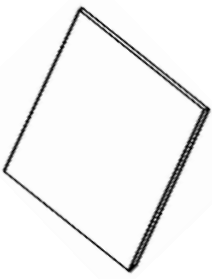
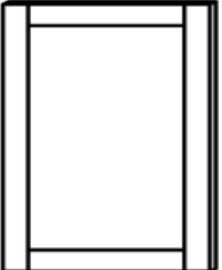
DECORATIVE VALANCE

	<p>NOTE: NARROWEST PART IS 11", WIDEST IS 15"</p>		WIDTH	HEIGHT	THICKNESS
		RPV30	30"	15"	3/4"
		RPV36	36"	15"	3/4"
		RPV42	42"	15"	3/4"
		RPV48	48"	15"	3/4"

SKIN PANEL						
			WIDTH	LENGTH	THICKNESS	
			PANEL 36*96	36"	96"	1/8"
			PANEL 48*96	48"	96"	1/8"
SAMPLE DOOR						
			WIDTH	HEIGHT	THICKNESS	
			SAMPLE DOOR LARGE	11½"	15"	3/4"
DENTALMOLDING						
			WIDTH	LENGTH	THICKNESS	
			DENTALMOLDING	1"	96"	3/4"
ROPEMOLDING						
			WIDTH	LENGTH	THICKNESS	
			ROPEMOLDING	1"	96"	3/4"
TOE KICK						
			WIDTH	LENGTH	THICKNESS	
			TK8(5MM)	4½"	96"	3/16"
			TK8(12MM)	4½"	96"	3/4"

CORBEL 6"

			WIDTH	HEIGHT	DEPTH
		CORBEL 6"	6"	10"	3 3/4"

ROSETTE BLOCK

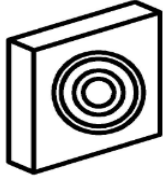
			WIDTH	HEIGHT	THICKNESS
		ROSETTE 3*3	3"	3"	3/4"

TURN POST

			WIDTH	DEPTH	HEIGHT
		DLS4*4*34.5	4"	4"	34 1/2"

PULL OUT TRAY

			WIDTH	DEPTH	HEIGHT
		PULL OUT TRAY 18"	18"	21"	4"
		PULL OUT TRAY 24"	24"	21"	4"
		PULL OUT TRAY 30"	30"	21"	4"

