

# Measurement Guide

## Before You Start

- Record all measurements in inches (do not round)
- Make sure that all recorded measurements are clearly legible
- Assign one person to determine and record all measurements

## Record Ceiling Heights & Wall Lengths

- Draw an outline of the room
- Record the ceiling height on your outline
  - Measuring from the floor to the ceiling or base of the soffit
- Record the wall lengths on your outline
  - Start in one corner of your project area and measure to an adjacent wall
  - Continue around the room until all necessary walls have been measured

## Measure Windows

- Include all window trim as part of the measurements for windows
- Measure and record each window's width, height, and the distance from the window to the floor on the outline
- Add window locations to your outline
  - Start at the corner of any wall that contains a window and measure to the outside trim or edge of the window
  - Continue around the room until all necessary windows have been added to your layout

## Measure Appliances

- Measure or research and record the width, height, and depth of your sink and all appliances
- Add the sink location to your outline
  - Start at the corner of the sink wall and measure to the center of your sink
- Add the appliance locations to your outline
  - Notate the location of your dishwasher in relation to your sink (left or right) if applicable
  - Start at the corner of the range wall and measure to the edge of your range
  - Start at the corner of the refrigerator wall and measure to the edge of your refrigerator

## Room Outline Example

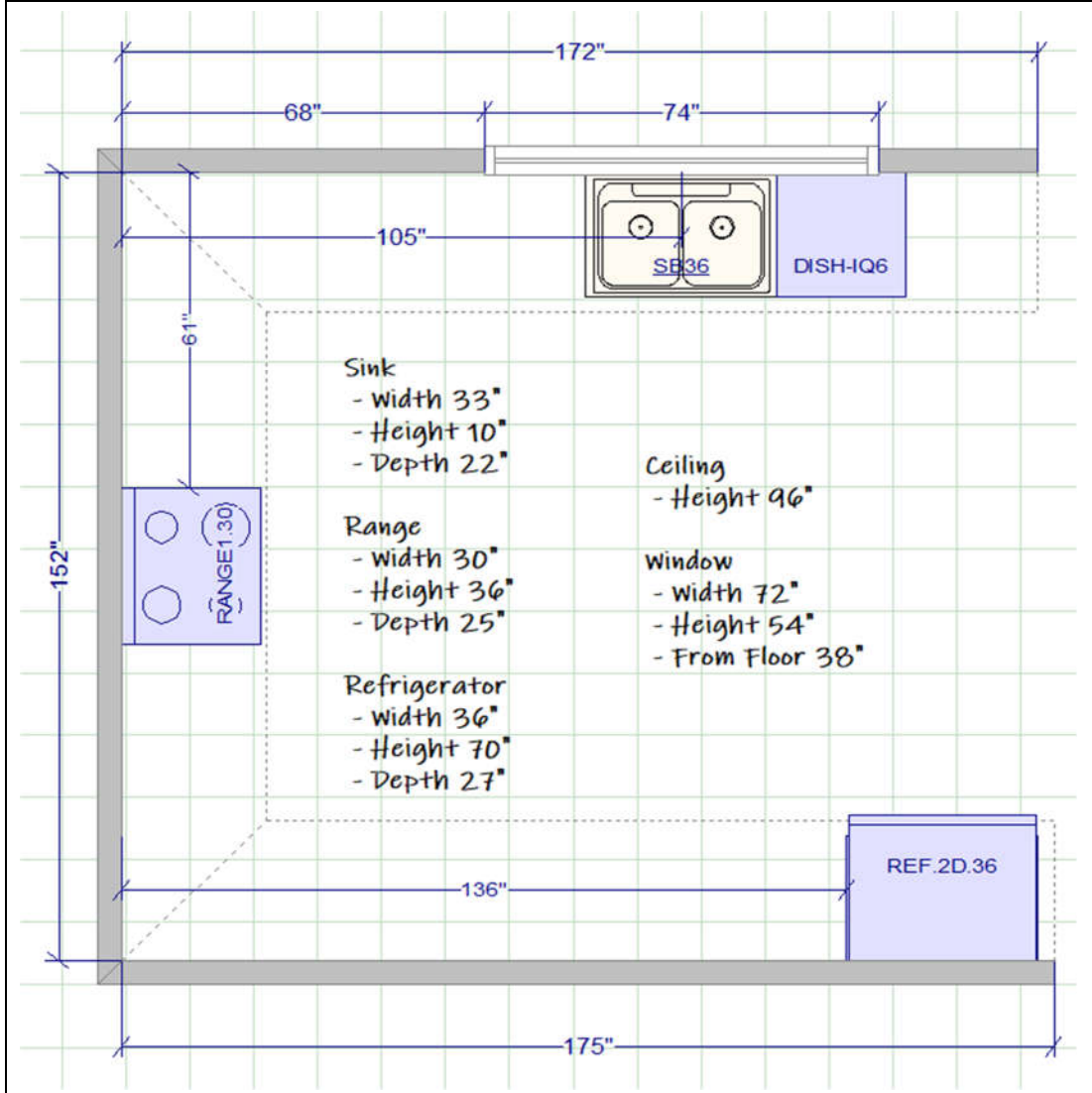

Unparalleled Quality. Unrivaled Convenience. Unbeatable Prices.